

16mmØ LED Indicator Lights (with integrated LED light source)

Date:
20th Dec 2005

Group:
SE-16D

Part Number:
SE-16D-IL-XXX-X-XX

Data Sheet:
SE-16D-IL

IEC-60947 GB-14048.5 IP40



16mmØ
Form-1A



16mmØ
Form-1B









16mmØ
Form-2A

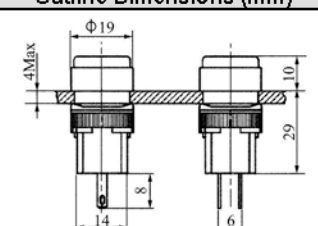

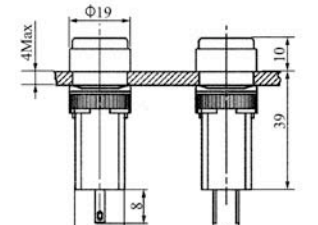
16mmØ
Form-2B

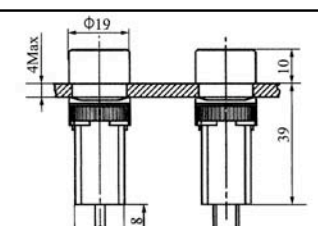

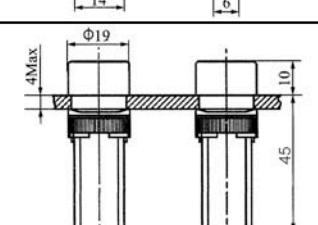
Product	Style	Type	Color	Lamp Voltage	Outline Dimensions (mm)
16mmØ Indicator Light (with 2.8mm solder tag termination)	 Form-1A	SE-16D-IL-F1A	R=Red G=Green Y=Yellow B=Blue W=White	21=6V AC/DC 22=12V AC/DC 23=24V AC/DC 24=36V AC/DC 25=48V AC/DC	
16mmØ Indicator Light (with 2.8mm solder tag termination)	 Form-1B	SE-16D-IL-F1B		26=110V AC/DC 27=127V AC/DC 28=220V DC only 31=220V AC only 32=380V AC only	
16mmØ Indicator Light (with 2.8mm solder tag termination)	 Form-2A	SE-16D-IL-F2A		21=6V AC/DC 22=12V AC/DC 23=24V AC/DC 24=36V AC/DC 25=48V AC/DC 26=110V AC/DC 27=127V AC/DC 28=220V DC only 31=220V AC only 32=380V AC only	
NEW 16mmØ Indicator Light (with finger-proof screw termination)	 Form-2B	SE-16D-IL-F2B			

Ordering Code: SE-16D-IL-XXX-X-XX

SE-16D-IL	-	XXX	-	X	-	XX
		F1A F1B F2A F2B		R=Red G=Green Y=Yellow B=Blue W=White		21=6V AC/DC 22=12V AC/DC 23=24V AC/DC 24=36V AC/DC 25=48V AC/DC 26=110V AC/DC 27=127V AC/DC 28=220V DC only 31=220V AC only 32=380V AC only

Drilling Hole

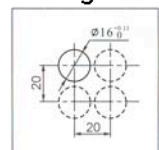

Technical Parameters

Environmental Temperature	-25°C ~ +55°C	Insulation Resistance	≥ 100MΩ	Electrical Life	50x10 ³ Hrs
Humidity	45 ~ 85%RH	Withstand Voltage	> 2000VAC	Protection Level	IP40
Contact Resistance	≤ 50mΩ				